



# MAPLE

LIVING

PROJECT: DEANSIDE VILLAGE,  
DEANSIDE, 3336

## FLOORPLAN LOT 2429

BEDROOMS: 4

BATHROOMS: 3

CAR GARAGE SPACES: 2

BUILD SIZE: 18.42sq

LAND SIZE: 156m<sup>2</sup>

Plans and landscaping are indicative only and may differ as a result of documentation and construction. Sizes may vary and dimensions listed are for indicative purposes only. Furniture not included in package.

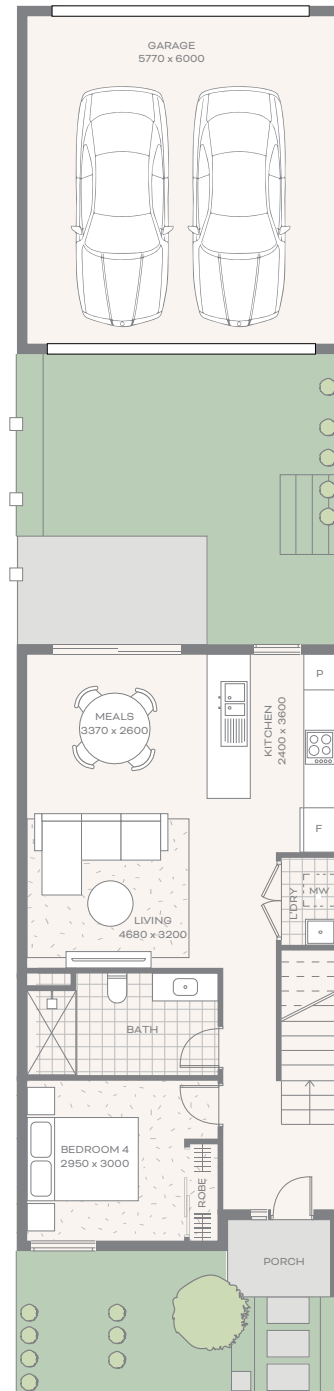

GROUND FLOOR

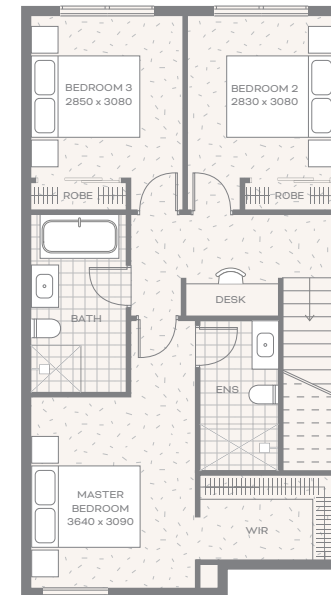

FIRST FLOOR